

## ESW 7010

14 cm high gourmet warming drawer without handle

for preheating crockery, keeping food warm and low temperature cooking.



- The ultimate in enjoyment – low temperature cooking
- Always at the right temperature – 4 functions
- Convenient and easy – Touch control
- Opening the drawer couldn't be easier – Push2open
- Better safe than sorry – timer function with automatic switch-off

EAN: 4002516925590 / Material number: 12802430

Construction type and design	
Appliance colour	Pearl Beige
Gourmet warming drawer	•
PureLine	•
VitroLine	•
ArtLine	•
Handleless	•
Operating modes	
Cup warming	•
Heating crockery	•
Keeping food warm	•
Low temperature cooking	•
User convenience	
Miele@home	•
Capacity	6 place settings
Push2open mechanism	•
Fully telescopic runners for easy loading and unloading of the warming drawer	•
Control panel with sensor controls	•
Control panel with symbols	•
Stop programming	•
Timer function	•
Sabbath programme	•
Cleaning convenience	
Flush control panel	•
Safety	
Cool front	•
Anti-slip mat	•
Safety switch-off	•
Technical data	
Temperatures min. in °C	40
Temperatures max. in °C	85
Appliance width in mm	595
Appliance height in mm	141
Appliance depth in mm	570
Useable interior height in mm	80
Total rated load in kW	0.70
Voltage in V	230
Frequency in Hz	50-60
Fuse rating in A	10
Number of phases	1
Mains cable with plug	•
Length of supply lead in m	2.0
Accessories supplied	
Anti-slip mat	1

## ESW 7010 Installation diagrams

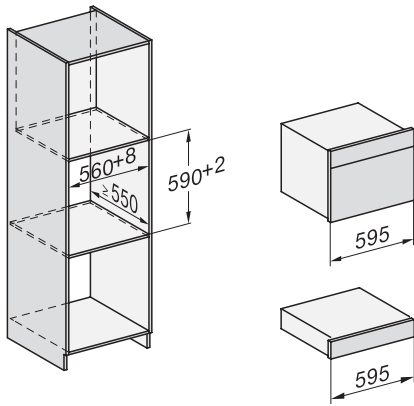

Installation, with 45 cm tall appliances,  
installation drawing

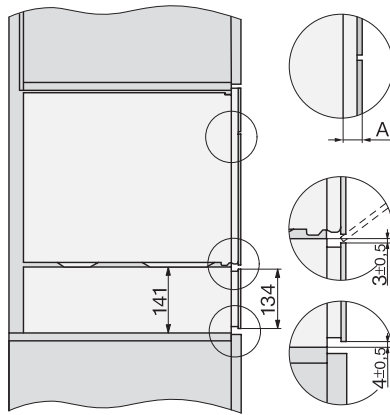

Side view, with 45 cm tall appliances,  
installation drawings

A) 22 mm – glass

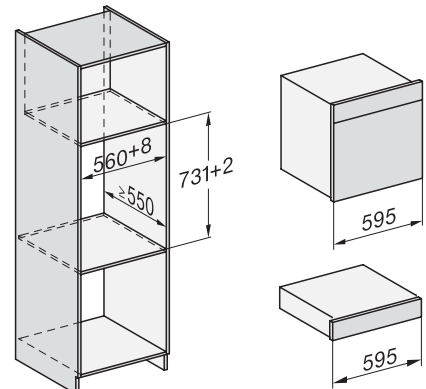

Installation, with 60 cm tall appliances,  
installation drawing

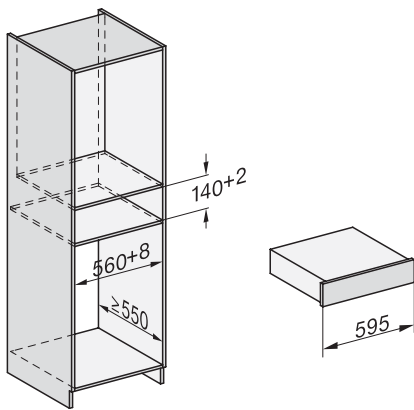

Built-in, installation drawing

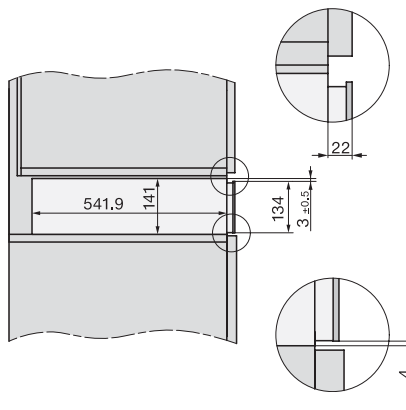

Side view, installation drawing

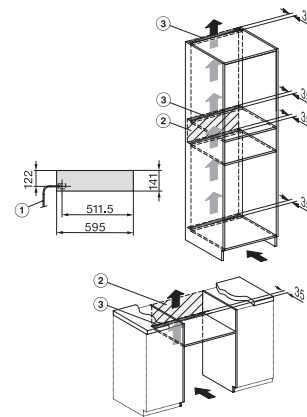

Installation drawing

- 1) Mains connection cable, L=2,000 mm
- 2) no connection in this area
- 3) ventilation cut-out min. 180 cm<sup>2</sup>