

RAMBLA

LUX610

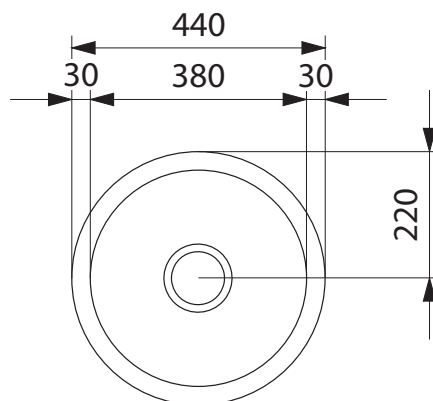

PRODUCT INFORMATION

| | |
|------------------|-----------------------|
| Installation | Topmount |
| Dimensions | ø440mm |
| Cabinet Base | 450mm |
| Bowl Size | ø380 x 190mm / 22L |
| Bowl Radius | ø440mm |
| Cut-Out Size | ø425mm |
| Cut-Out Template | No |
| Waste Outlet | Semi Integrated Waste |
| Overflow | No |
| Tap Holes | No |
| Remote Waste | No |
| Finish | Stainless Steel |
| Warranty | 50 Years |

NOTE: Cut-out dimensions are a guide only, please use the actual sink as your template.

FEATURES & BENEFITS



Food
Preparation
Centre



18/10
Stainless
Steel



Sound
Deadening
Pads

ACCESSORIES

— Included Accessory
- - - Available Accessory



RM44
Rollamat

- - - -

BARE SINK OPTION AND SOME SINK & TAP PACKAGES DO NOT INCLUDE ACCESSORIES.
PLEASE CHAT TO YOUR SALES CONSULTANT FOR FURTHER INFORMATION.

LAST UPDATED: 21 SEPTEMBER 2021

FRANKE